

DEPTHS RANGING FROM 4-1/2" TO 14" ARE AVAILABLE.  
DIMENSION "D" IS AVAILABLE IN 7/16", 9/16", & 5/8" ON CUSTOM DESIGNS.

MASONRY FRAMES, DOUBLE RABBET FRAMES (WITH UNEQUAL RABBETS) ARE ALSO AVAILABLE IN A RANGE OF DEPTHS FROM: 4-5/8" THRU 14" IN 1/8" INCREMENTS. 4" FACE HEADS WITH 2" FACE JAMBS ARE ALSO AVAILABLE IN SELECTED SIZES.

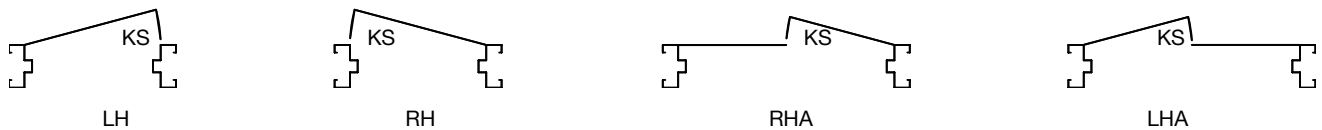

**OUTSIDE**

SUFFIX "A" = ACTIVE LEAF OF PAIRS

"KS" = KEY SIDE

# DRYWALL FRAMES

HARDWARE LOCATIONS SHOWN MATCH STEELCRAFT STANDARD DOORS.

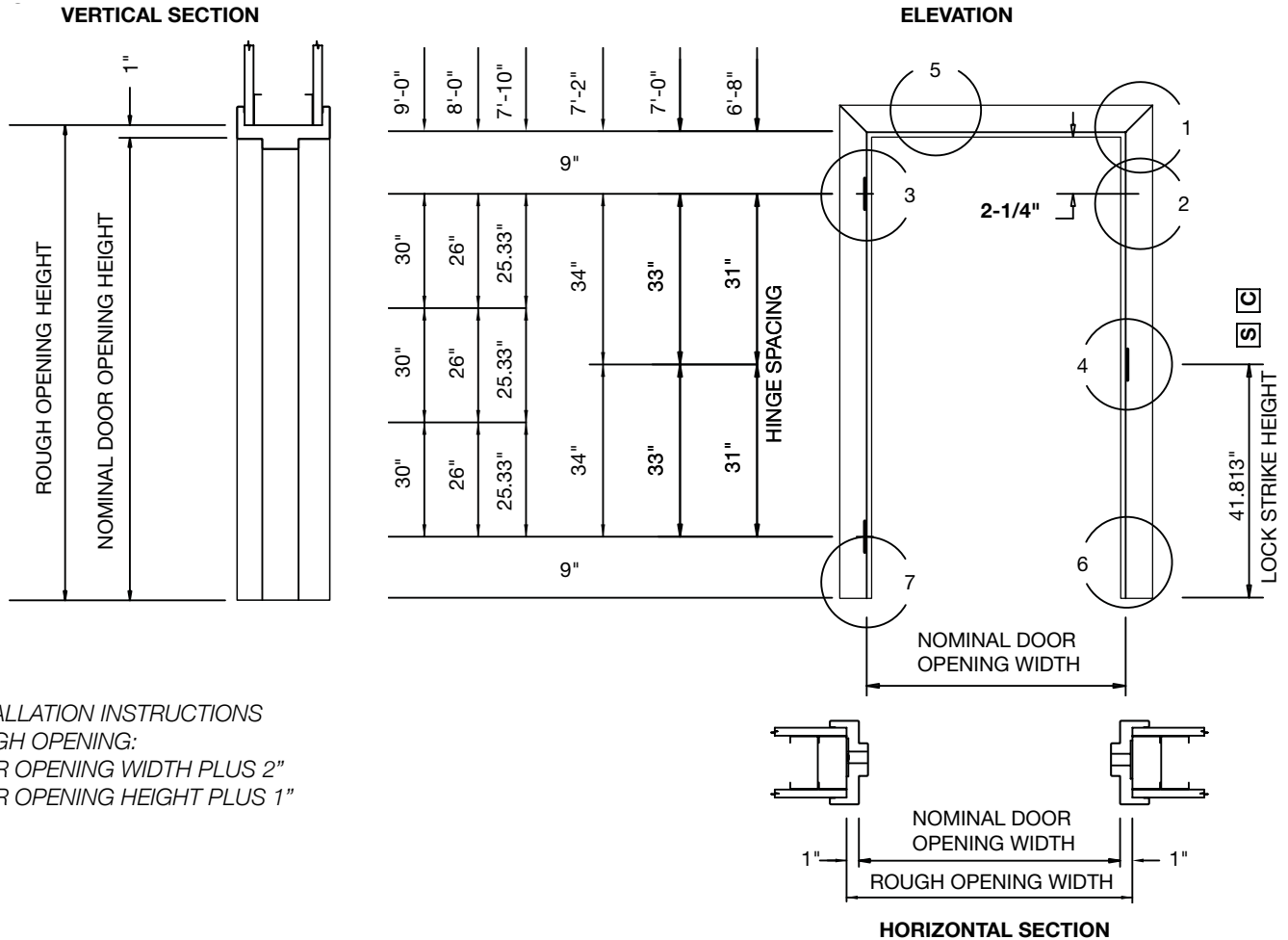

**INSTALLATION INSTRUCTIONS**  
ROUGH OPENING:  
DOOR OPENING WIDTH PLUS 2"  
DOOR OPENING HEIGHT PLUS 1"

**STEP 1**

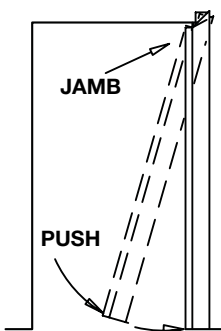

- A. PUSH TOP OF ONE JAMB OVER THE WALL.
- B. HOLD TOP OF JAMB IN PLACE, THEN PUSH BOTTOM IN TOWARDS AND OVER WALL.

**STEP 2**

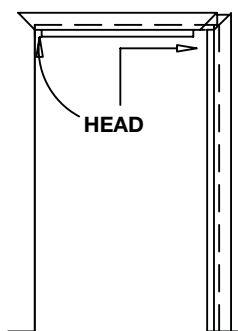

- A. POSITION FRAME HEAD OVER THE WALL.
- B. ALIGN HEAD TABS WITH JAMB SLOTS, THEN SLIDE HEAD TOWARD JAMB AND ENGAUGE TABS IN SLOTS.

**STEP 3**

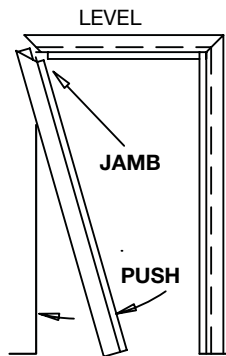

- A. PUSH TOP OF REMAINING JAMB OVER WALL AND MATE TABS IN SLOTS.
- B. PUSH BOTTOM OF JAMB IN TOWARDS AND OVER WALL.
- C. LEVEL HEAD.

**STEP 4**

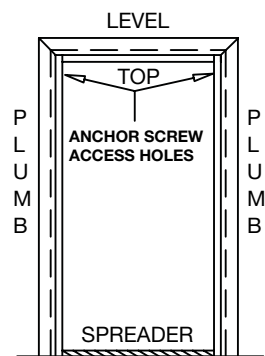

- A. ADJUST PLUMB ANCHORS WITH SCREWDRIVER.
- B. INSERT (4) #8 X 1/2" MIN. PHSMS THROUGH HOLES IN HEAD BACKBENDS AND FASTEN TO JAMB MITER GUIDES. (REQUIRED FOR LABELED FRAMES)
- C. PLUMB HINGE JAMB AND ANCHOR SILL.
- D. WITH TEMPORARY SPREADER, ADJUST STRIKE JAMB AND ANCHOR SILL.
- E. INSTALL MUTES.

# DRYWALL FRAMES

## 1 KNOCKED DOWN CORNER CONSTRUCTION

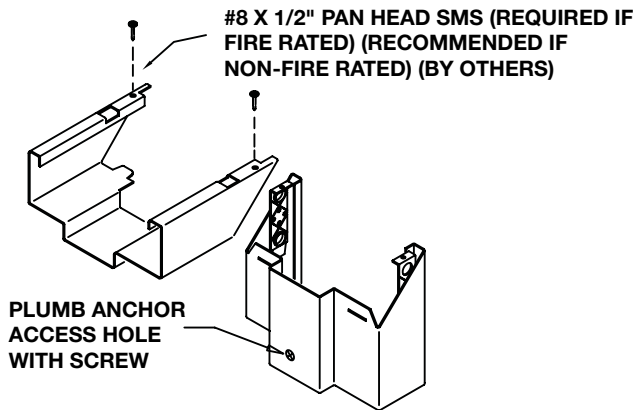

## 2 ADJUSTABLE PLUMB ANCHOR

ONE EACH JAMB FOR OPENING HEIGHTS THRU 7'2". ONE ADDITIONAL FOR OPENING HEIGHTS > 7'2".

ADJUST WITH SCREWDRIVER

DUAL PLUMB ANCHORS ARE APPLIED IN DEPTHS GREATER THAN 8-3/4".

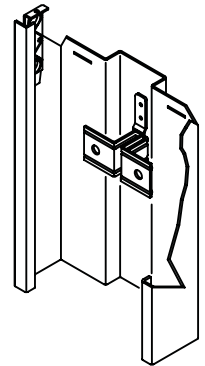

## 3 HINGE PREPARATION

4-1/2" X .134" OR 4-1/2" X .180" ANSI A156.7 TEMPLATE  
7 GAUGE STEEL REINFORCING

BACKSET: 5/16"

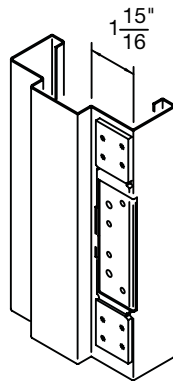

## 4 STRIKE PREPARATION

**S** DRILLED AND TAPPED FOR 12-24 MS (2) PLACES  
UNIVERSAL (4-7/8") ANSI A115.1 & 2 TEMPLATE

12 GAUGE STEEL REINFORCING STANDARD FOR 1-3/4" DOORS

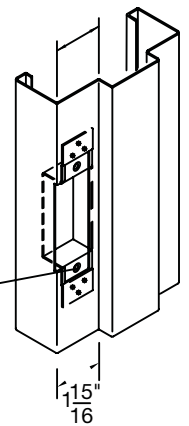

## 4 LOCK STRIKE PREPARATION

**C** CYLINDRICAL (2-3/4") ANSI A115.3 TEMPLATE  
16 GAUGE STEEL REINFORCING WITH EXTRUDED SCREW HOLES PROVIDES EQUIVALENT SCREW ENGAGEMENT EQUAL TO 14 GAUGE

ALSO AVAILABLE WITHOUT LIP CUTOUT FOR DEADLOCKS

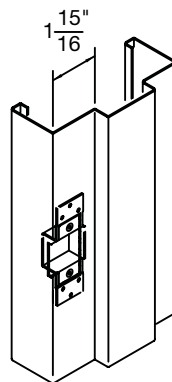

## 5 CLOSER REINFORCEMENT (OPTIONAL)

14 GAGE STEEL

(HEAD)

FULL DEPTH CLOSER REINFORCEMENT (SHOWN)

HALF SLEEVE OR PLATE ALSO AVAILABLE

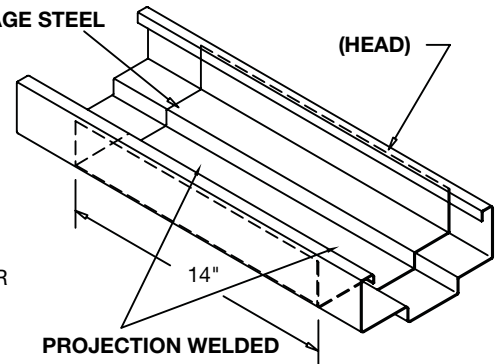

## DOOR SILENCER (MUTE)

RUBBER MUTE (3) / STRIKE JAMB (2) / DOUBLE SWING HEAD

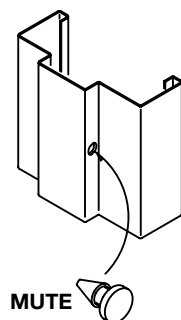

## 6 STANDARD SILL ANCHOR

DIMPLED HOLE FOR #10 FH FASTENER. FASTENERS ARE BY CONTRACTOR AND MUST BE LONG ENOUGH TO ENGAUGE STUD.

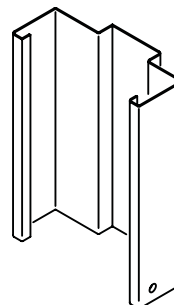

## 7 OPTIONAL SILL STRAP ANCHOR

FASTENERS ARE BY CONTRACTOR AND ENGAUGE STUD

ONE PIECE

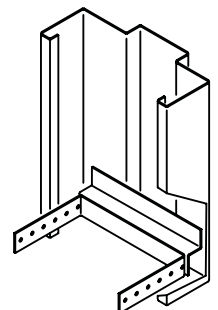

# DRYWALL FRAMES

**STANDARD SIZES  
NOMINAL DOOR OPENING**

WIDTH		HEIGHT
SINGLE	DOUBLE	
2'-0"	4'-0"	
2'-4"	4'-8"	
2'-6"	5'-0"	6'-8"
2'-8"	5'-4"	7'-0"
2'-10"	5'-8"	7'-2"
3'-0"	6'-0"	7'-10"
3'-4"	6'-8"	8'-0"
3'-6"	7'-0"	9'-0"
3'-8"	7'-4"	
3'-10"	8'-0"	
4'-0"		

**FIRE DOORS**

**LABELING AGENCIES :**

UL SOLUTIONS  
WARNOCK HERSEY  
FACTORY MUTUAL

**TEST:** UL 10C, UL 10B, UL 1784,  
& NFPA 252

**RATING:** 20 MIN, 3/4 HR,  
1 HR OR 1-1/2 HR

**MAX. SIZE:** 14 GAUGE STEEL  
16 GAUGE STEEL  
4'0" X 9'0" SINGLE  
8'0" X 9'0" PAIR

18 GAUGE STEEL  
4'0" X 7'0" SINGLE  
6'10" X 7'0" PAIR

*NOT ALL RATINGS ARE  
AVAILABLE IN ALL SIZES,  
DESIGNS AND MATERIALS.*

**PRODUCT SPECIFICATIONS:**

Drywall Frame for 1-3/4" doors are formed from commercial quality cold rolled steel conforming to ASTM A1008 ...or (optional) hot-dipped galvanized or galvanized steel conforming to ASTM A924 and A653 - see chart below.

Frames are knocked down (K.D.) field assembled type or welded unit type. Head and jamb members of K.D. frames have diecut mitered corners that interlock rigidly when field assembled. Integral door stops are 5/8" high. Jambs are sized to suit wall applications. Twist-in anchors are available for new masonry, wood stud, metal stud, or existing opening wall conditions (indicate which). Floor anchors or extra jamb anchors are provided to anchor sill. Welded-in jamb anchors are also available.

**Hardware Provisions:** Frames are handed. Hinge jambs are mortised for 4-1/2" or 5" high, standard and heavy weight hinges (specify which). 7 gauge steel reinforcements are welded in place and are drilled and tapped for fasteners in accordance with ANSI A156.7. The strike jamb is prepared for 4-7/8" universal or 2-3/4" cylindrical strike in accordance with ANSI A115.1 & 2 (specify which). Plaster guards are provided. Optional closer reinforcement is a 14 gauge steel formed steel sleeve (12 gauge upon request). 3 mute holes are provided per strike jamb and 2 for double swing heads.

**Paint:** FORTIS DOORS frames are provided with one coat of oven-cured neutral color primer paint. Primer coat shall conform with ANSI A250.10. The primer coat is a preparatory base for necessary finish painting. "Colorstyle" finish coat is also available on K.D. frames from a selection of standard colors (optional). Colorstyle finish is electrostatically applied, oven-cured urethane enamel, and shall conform to ANSI A250.3.

**MATERIAL**

DOOR FRAME MATERIAL	LEVEL	C.R.	GALV	
			A60	G90
18 GAUGE STEEL	STANDARD DUTY	STD	OPT	N/A
16 GAUGE STEEL	STANDARD, HEAVY, OR EXTRA HEAVY DUTY	STD	OPT	OPT
14 GAUGE STEEL	MAXIMUM DUTY	STD	OPT	OPT

*18 GAUGE STEEL FOR USE  
WITH 1-3/4" WOOD DOORS.*

**PERFORMANCE**

<b>PHYSICAL ENDURANCE LEVEL:</b>	MEETS ANSI A250.4 PERFORMANCE TEST -- 16 & 14 GAUGE STEEL: LEVEL A (1,000,000 CYCLES)
----------------------------------	---

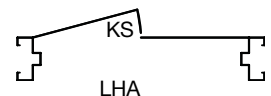
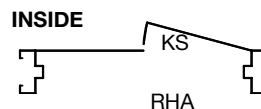
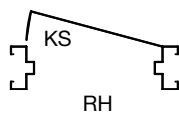
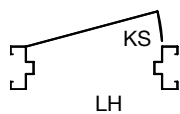

"KS" = KEY SIDE      "SUFFIX" A" = ACTIVE LEAF OF PAIRS

(CONVERSION: 1" = 25.4 MM, E.G., 1-3/4" = 44.45 MM)